

# Order Form

# Made-to-Length 100mm Linear Drainage



### Product Details

**Product Code** 100AAi20MTL  
**Grate Style** Wave Grate  
**Stormtech Range** 100  
**Channel Material** Stainless Steel  
**Grate Material** Aluminium

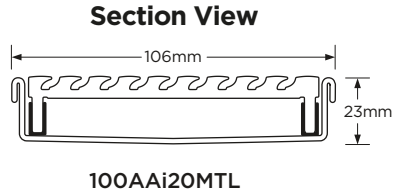

### Finish / Code

- Standard / Satin**  100AAi20MTL
- Matte Black**  100AAi20MTL-Black
- Brass Gold**  100AAi20MTL-BG

**Please note:** Only Aluminium grate is finished, channel is stainless steel

### Specify Length, Outlet Size and Position

#### 1. Label

  
 mm

#### Outlet Size

- 38mm  44mm
- 51mm  63mm
- 76mm  89mm

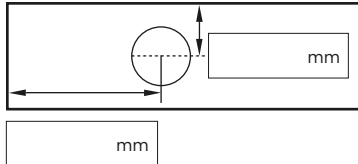

#### Notes

#### 2. Label

  
 mm

#### Outlet Size

- 38mm  44mm
- 51mm  63mm
- 76mm  89mm

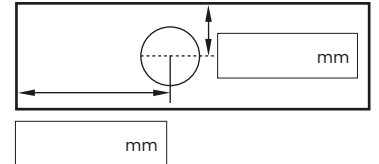

#### Notes

#### 3. Label

  
 mm

#### Outlet Size

- 38mm  44mm
- 51mm  63mm
- 76mm  89mm

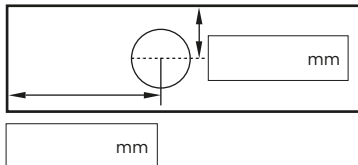

#### Notes

#### 4. Label

  
 mm

#### Outlet Size

- 38mm  44mm
- 51mm  63mm
- 76mm  89mm

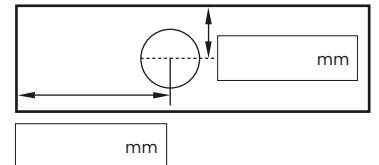

#### Notes

#### 5. Label

  
 mm

#### Outlet Size

- 38mm  44mm
- 51mm  63mm
- 76mm  89mm

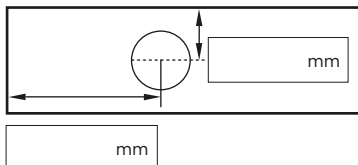

#### Notes

#### 6. Label

  
 mm

#### Outlet Size

- 38mm  44mm
- 51mm  63mm
- 76mm  89mm

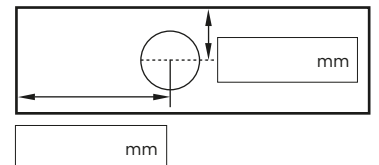

#### Notes

**PLEASE NOTE** See AS3500 standard & local regulator for specific outlet/drain requirements. Grates longer than 1500mm are supplied in multiple sections. Channels are a maximum 3000mm in one piece, channels over 3000mm are supplied in multiple sections with joiner. +/- 2mm tolerance on dimensions.

#### Full Name

#### Company Name

#### Telephone

#### Email

#### Signature

Phone 01483 346 460

Email [technical@slimlinedrain.co.uk](mailto:technical@slimlinedrain.co.uk)

[slimlinedrain.co.uk](http://slimlinedrain.co.uk)